

Exterior Access Panels

Larsen's exterior access panels (**L-XT**) are designed to provide efficient and quick access in exterior applications. The insulated and gasket panel design keeps the elements out of the building - even in the harshest environments. Dual acting handles allow convenient access from inside or outside the building.

L-XT



Exterior Access Panels



Optional locking handle does not have an inside handle

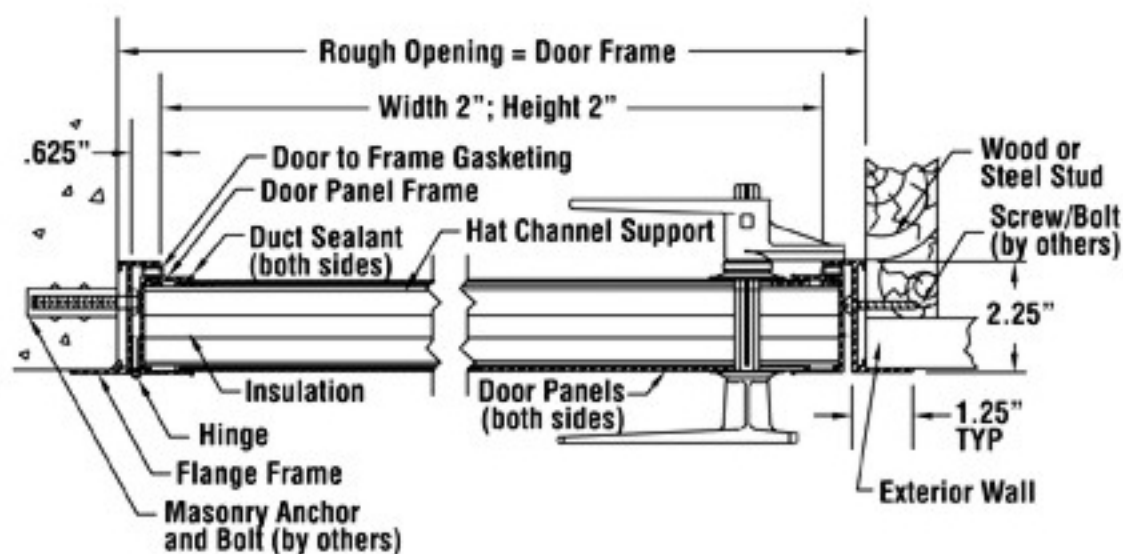

L-XT	Part	Description
X	Door	20 ga. cold rolled
X	Door	[Optional .060" aluminum]
X	Frame	6063-T5 extruded aluminum
X	Flange	.080" 6063-T5 extruded aluminum
X	Hinge	Stainless steel continuous piano hinge
X	Latch	Two dual-acting handles
X	Latch	[optional lockable handle]
X	Finish	Paint Grip
X	Insulation	2" Fiberglass

Width x Height		Latches
mm	inches	
305 x 305	12 x 12	1
457 x 457	18 x 18	1
559 x 762	22 x 30	2
559 x 914	22 x 36	2
610 x 610	24 x 24	1
610 x 762	24 x 30	2
610 x 914	24 x 36	2
610 x 1219	24 x 48	2
610 x 1524	24 x 60	2
914 x 914	36 x 36	2
914 x 1219	36 x 48	2
914 x 1524	36 x 60	2
1219 x 1219	48 x 48	2

Rough Opening = Panel Size

All access panels are hinged on the second dimension (height).

CALL 1-800-LARSENS (527-7367) / FAX (763) 571-6900